

Marmor

Low-Voltage Track



- White
● Black

Features



Dimensions

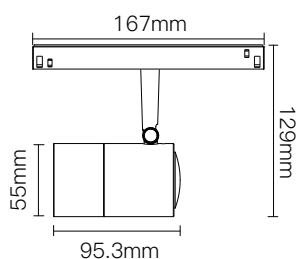

16.2mm

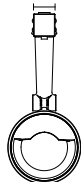

Electrical system

Total power consumption:	12W
Power input:	48V
Operating temperature:	-10°C ~ 35°C
Dimming option:	0-10V / Dali / Casambi
Insulation class:	Class III

Light source

LED type:	COB
CCT:	2700K/3000K/4000K
CRI:	Ra>92
Beam angle:	Wallwash
UGR:	NA

Housing

Lamp body diameter:	55mm
Material:	Aluminum
Weight:	293g

Warranty

Period:	5-year warranty
----------------	-----------------

Lumen output

BA. \ CCT	2700K	3000K	4000K
Wallwasher	515lm	541lm	573lm

Nomenclature

*Applicable model: M41512xx90xxxx (xx: dynamic codes)

Product Code	System Power	CCT	CRI	Beam Angle	Driver/Control	Serial No.
M415	12(12W)	27(2700K)	90(90)	WW(Wallwash)	N(Non-Dim)	01(Black)
		30(3000K)			A(0-10V dim)	02(White)
		40(4000K)			D(DT6)	
					E(DT8)	

Illuminance distance data

Marmor

12W



Wallwasher

h(m)	E(lx)	Ø (m)	S_B(sq.m)
1	688.68	0.77	0.5
2	172.17	1.53	2.0
3	76.52	2.30	4.5
4	43.04	3.06	8.0
5	27.55	3.83	12.5