

Trimless Downlight Installation Instructions

RoboRadar Applicable model: R10120xx90xxxxx



WARNING: RISK OF ELECTRIC SHOCK! TURN OFF POWER BEFORE INSTALLING OR SERVICING.

⚠ WARNING:

1. Risk of fire or electric shock. LED fixtures installation requires knowledge of electrical luminaires systems. Installation should be performed only by a qualified electrician in accordance with the National Electrical Code and relevant local code.
2. Read all product labels and instructions before installing the fixture.
3. To prevent wiring damage or abrasion, do not expose wiring to edges of sheet metal or other sharp objects.
4. **THE INSTALLATION SHOULD ONLY BE PERFORMED AFTER THE POWER OF THE FIXTURE HAS BEEN DISCONNECTED.**
5. **SAVE THESE INSTRUCTION FOR FIXTURE REFERENCE.**



220-240 VAC

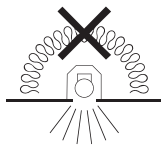

DO NOT COVER
WITH THERMAL
INSULATION.



INDOOR
USE ONLY.



DO NOT TOUCH
WHILE FIXTURE
IS IN OPERATION.

Luminaire Installation

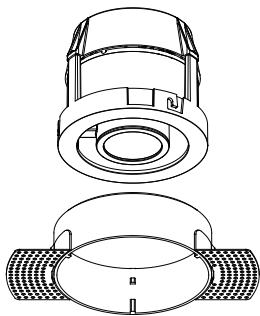

① Lamp x1

② Mounting frame x1



③ Screw x4



ON Lichttechnik GmbH
Siegbergstraße 73
57072 Siegen
T +49 (0) 271 233 749-61
E info@on-lichttechnik.de
on-lichttechnik.de

Trimless Downlight Installation Instructions

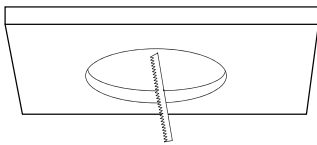

- 1 Cut ceiling opening to recommended dimension according to the product datasheet.

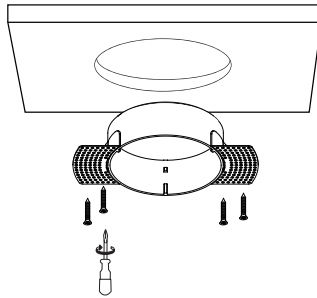

- 2 Place the mounting frame onto the ceiling. Fasten to ceiling with screws.

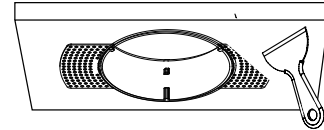

- 3 Patch over the mounting frame with stucco or plaster and paint per ceiling color and let it dry.

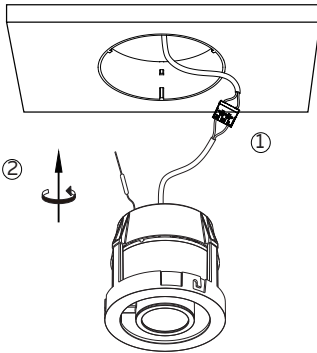

- 4 Connect the luminaire to the AC power supply. Insert the fixture in the mounting frame and twist, making sure the lugs engage fully in the latching slots. To remove, push upwards to release.

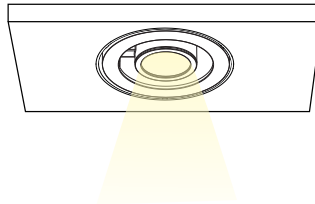

- 5 Restore the power supply.

