

# Downlight Installation Instructions

## ROBOCAN Zigbee version

Applicable model: DLRC28xx90xx4xx (xx: dynamic codes)



**WARNING: RISK OF ELECTRIC SHOCK! TURN OFF POWER BEFORE INSTALLING OR SERVICING.**

### READ AND FOLLOW ALL SAFETY INSTRUCTIONS

**WARNING:**

Product must be installed in accordance with your local electrical regulations and installed by a qualified electrician.



220-240 VAC

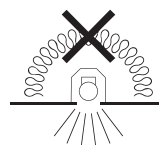

DO NOT COVER WITH THERMAL INSULATION.



INDOOR USE ONLY.



DO NOT TOUCH WHILE FIXTURE IS IN OPERATION.

### Luminaire Installation

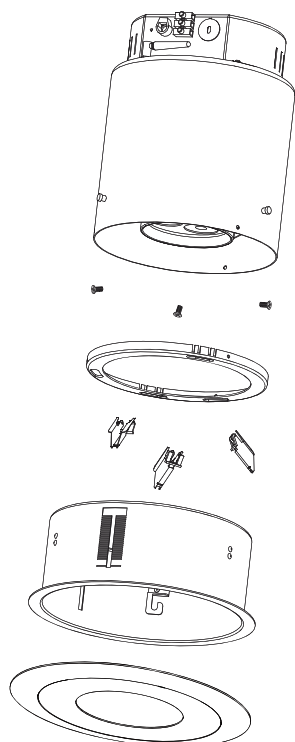

- 1 Lamp x1
- 2 Screw x3
- 3 Front trim x1
- 4 Clip x3
- 5 Embedded housing x1
- 6 Fixed trim x1

# Downlight Installation Instructions

## ROBOCAN Zigbee version

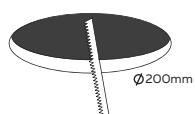

1 Ceiling cutout 200mm.

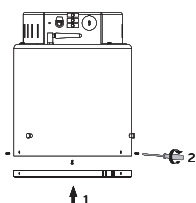

2 Assemble the front trim and the lamp using three screws.

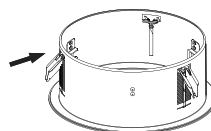

3 Put the clip on the embedded housing.

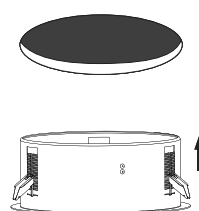

4 Insert embedded housing into the ceiling cutout.

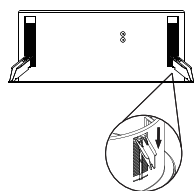

5 Push the clips down against the ceiling.

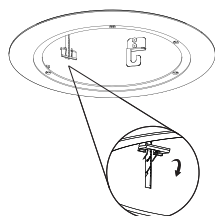

6 Press the snap lock down to fix the lamp in position.

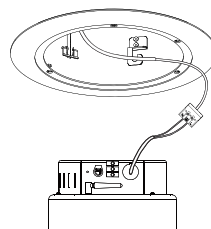

7 Connect the luminaire to the AC power supply.

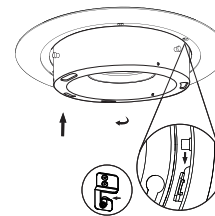

8 Insert the fixture in the embedded housing and twist, making sure the lugs engage fully in the latching slots.

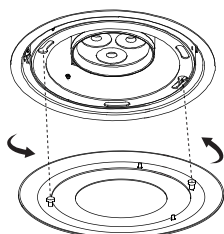

9 Fix the fixed trim onto the fixed trim latch, making sure the lugs engage fully in the latching slots.

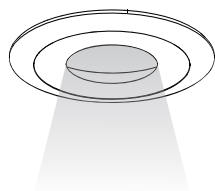

10 Restore power supply.